



# ALGARVE

TECHNICAL DATA SHEET



# DISCREET INDOOR & OUTDOOR HEATER

## LIGHTWEIGHT AND EASY TO INSTALL

This entry level 1.5kW commercial low glare heater discreetly enhances both indoor and outdoor environments. The Algarve is ideally used in smaller intimate areas and mainly used in commercial parasols and canopies (brackets available as an optional extra). Tansun offers a range of accessories and controllers compatible with the Algarve.



## COST EFFECTIVE SOLUTION

This energy saving light weight model is fitted with the latest Tansun low glare lamp which has proven to produce more heat than many 2.0kW heaters on the market. With running costs as low as 12p per kW hour the Algarve provides instant shortwave heat together with an inviting ambient low glare glow.

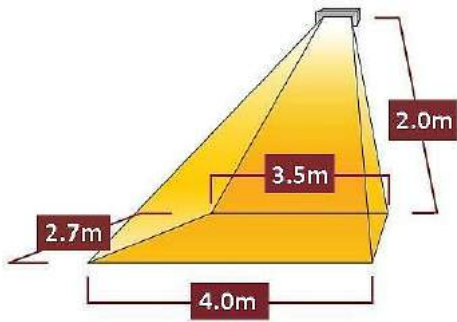

WALL MOUNTED AT 45 DEGREES

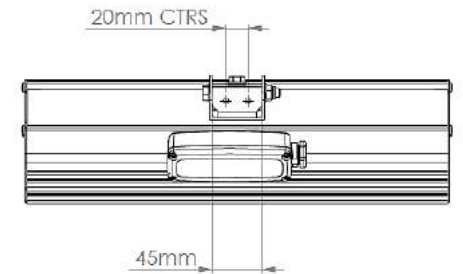
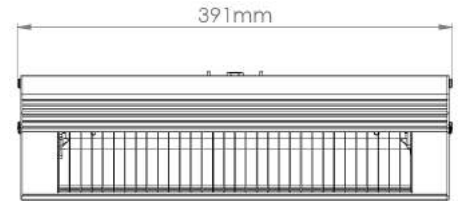
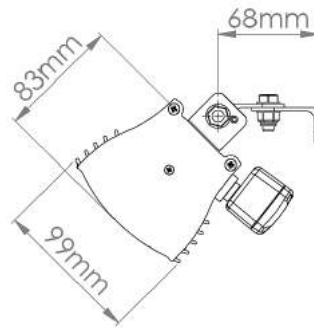

Model	Voltage (V)	Lamps x Power (kW)	Total Power (kW)	Minimum height from floor	Minimum distance from ceiling	Minimum distance from side wall	Weight without guard	Body Dimensions (W x H x D) (mm)
ALG 513	230	1 X 1.3	1.3	2.0m	0.3m	1m	2.4kg	391 x 99 x 83
ALG 515	230	1 X 1.5	1.5	2.0m	0.3m	1m	2.4kg	391 x 99 x 83



# ALGARVE APPLICATIONS

